

Control of Condensation in Buildings

Product Information Sheet

Circular Soffit Vents – G700

Description

Circular Soffit Vents can be utilised for new build projects but are most commonly used as the easiest solution for existing soffits on houses with condensation problems. Standard fixing for this product is a simple push twist action into a 70mm hole drilled in the soffit board.

The vent features evenly spaced 4mm slots small enough to prohibit large insects gaining access but wide enough not to be blocked by debris, paint or water droplets.

This product should be used in conjunction with the Roll Panel Vent (G502) or Eaves Vent (EV25) to ensure continuous airflow into the roof void.

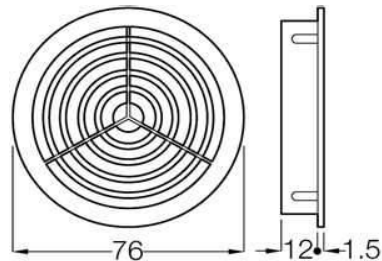

Product Specification

- 2150mm² of airflow per G700 unit
- To achieve 10,000mm²/m of free airflow, the G700 should be fitted at 200mm centres
- To achieve 25,000mm²/m of free airflow, the G700 should be fitted at 86mm staggered centres
- Push fit into 70mm diameter hole in soffit board

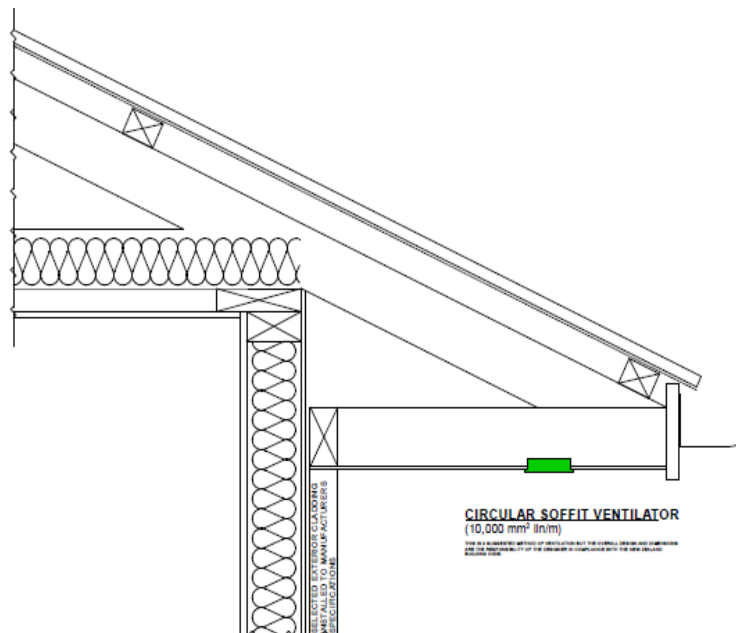

Note: These diagrams are for guidance purposes only. The overall design is the responsibility of the designer as there are often other factors to consider.